

# HABITAT CENTRAL 340 HRV

EC  
Motor

2  
Year

Two year  
replacement  
warranty

Premium centralised Heat Recovery unit - introduce fresh, filtered air into your home.

fanco



**Enthalpy** ensures the unit recovers heat & humidity.

## Key Features

Regenerating Efficiency	Up to 92%
Current (A)	1.6
Max Power (w)	180
Extract Filter	G4
Supply Filter	G4 (Optional F8 & H13)
Filter Replacement Alert:	Yes
Weight (kg)	37.7

## 5 Speeds

300 m <sup>3</sup> /hr @ 100 Pa	180w
250 m <sup>3</sup> /hr @ 50 Pa	125w
210 m <sup>3</sup> /hr @ 50 Pa	70w
150 m <sup>3</sup> /hr @ 50 Pa	50w
100 m <sup>3</sup> /hr @ 50 Pa	30w

Suitable for RS485 Modbus  
for SMART Home

## Dimensions (mm)

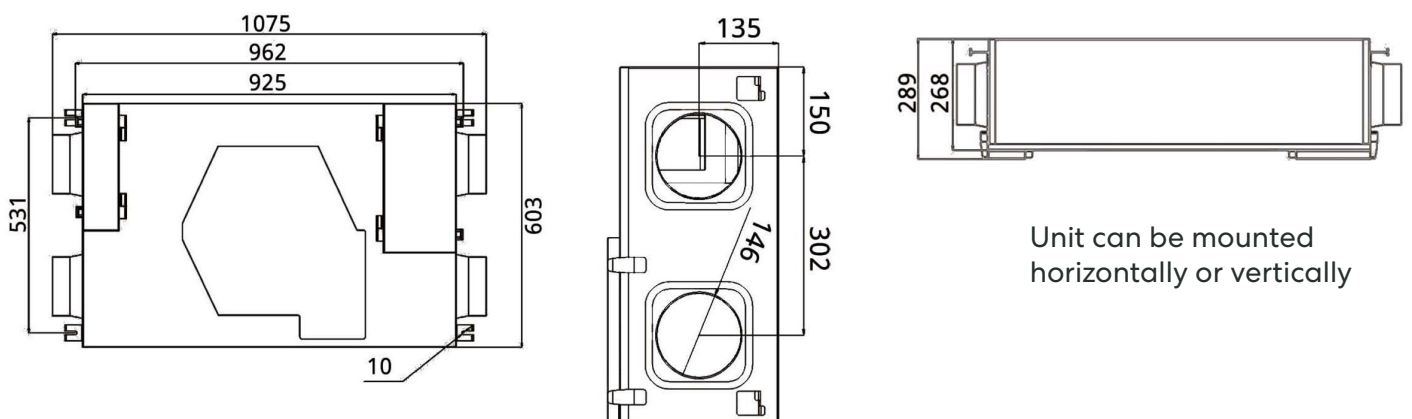

Unit can be mounted  
horizontally or vertically

# Operation Modes

**Manual**

**Away Mode**  
Fan speed reduced to low level to maintain air quality

**Timer (Schedule)**  
Adjust fan speed based on a schedule

**Automatic**

Automate based on schedule and/or sensor detection.

**IAQ Control**

Indoor Air Quality Control - Unit can dynamically adjust based on real time data from sensors

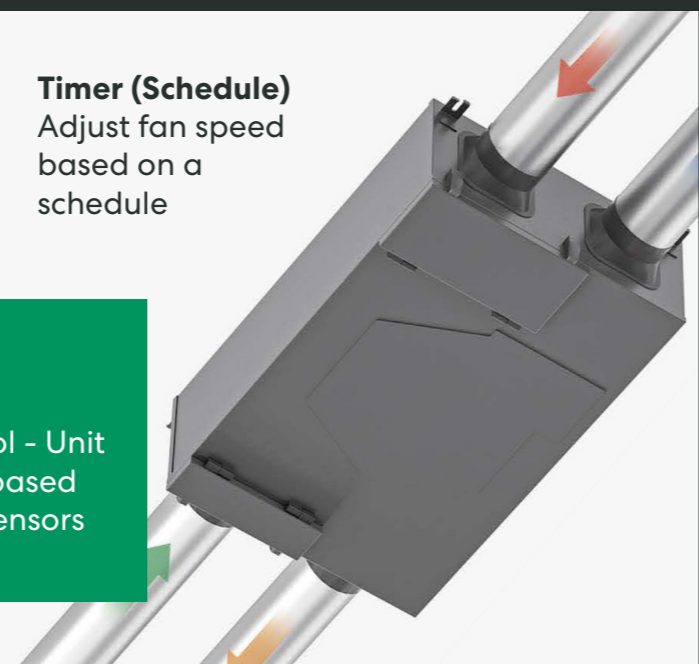

# Product Structure & Internal Sensors

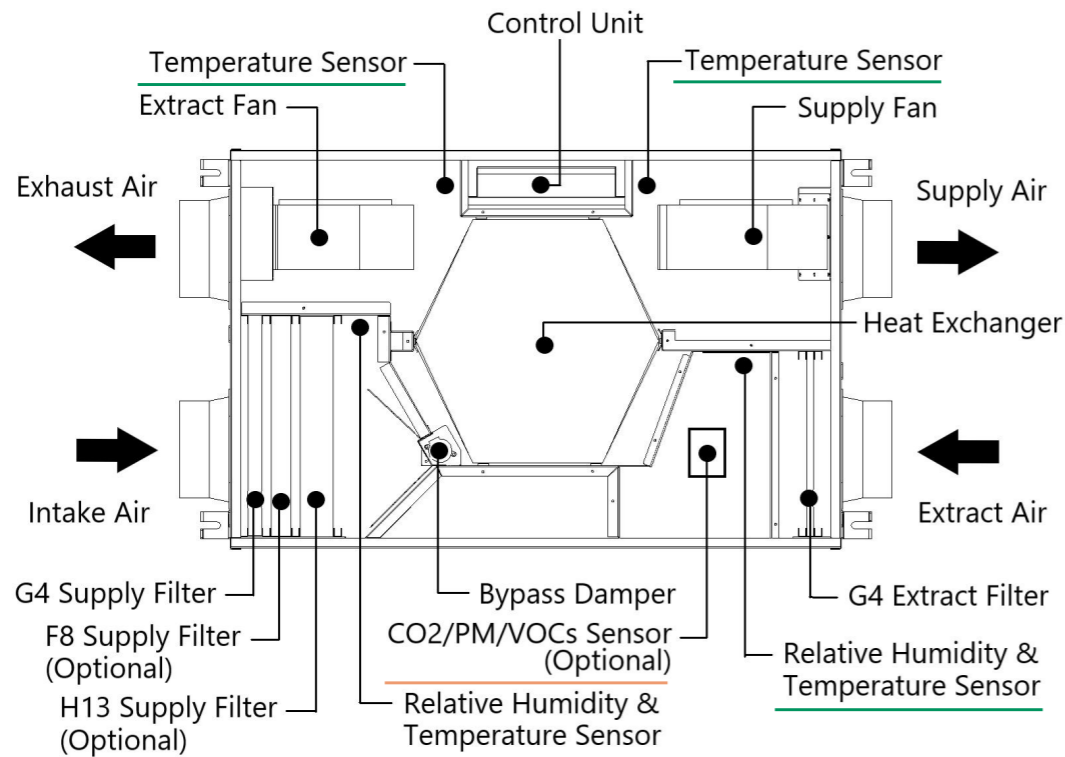

Included as Standard

## Relative Humidity & Temp Sensors

Relative Humidity & Temperature sensors within each chamber ensure that the unit can operate automatically based on these variables.

Optional Accessory

## CO2, VOC & PM2.5 Sensor

This optional sensor is installed inside the HRV unit, and ensures comprehensive indoor air quality control.

# Control Options



## Standard

Wall Control  
Can be used on its own or paired with WIFI

3.5" Wall Mounted Controller

Provides full control, but does not allow for parameter and setting adjustment of timer, boost duration and all sensors (see below).



## Premium

Wall Control  
Can be used on its own or paired with WIFI

7" Wall Mounted Controller

Premium controller is required if you wish to adjust parameters and settings of timer, boost duration and all sensors.

Pair this controller with the WIFI module to access external sensors, app control & full setting customisation.



## WIFI

Module

Can be used on its own, controlled via app or paired with wall control

WIFI module allows control of unit via app

External Sensors require WIFI module

# Setting Customisation

The Premium wall control is required to configure settings beyond factory default.

Control Type	Standard	Premium	WIFI Module
External Sensors	✓	✓	✓
Bypass Temperature	✓	✓	✓
Defrost Temperature	✓	✓	✓
Boost Duration	✓	✓	✓
Timer	✓	✓	✓
Away Mode	✓	✓	✓
Filter Reset	✓	✓	✓

✓  
Functionality is available

Settings can be configured

## External Sensors

External wireless sensors can also be purchased as an optional accessory. These are designed to be installed specifically within rooms for even greater levels of control.

**3 Options**  WIFI Module required for all external sensors

### Option 1



Relative Humidity & Temperature

### Option 2



Relative Humidity, Temperature & CO2

### Option 3



Relative Humidity, Temperature & PM2.5

Up to 8 external sensors can be connected per unit.

## Installation Example

**Option 1** sensors in wet areas such as bathroom or kitchen, ensure automation based on temperature and humidity levels

**Option 2** or **Option 3** sensors are typically installed in bedrooms or other living areas, in order to control levels of CO2 or PM2.5 particles, in addition to relative humidity and temperature.

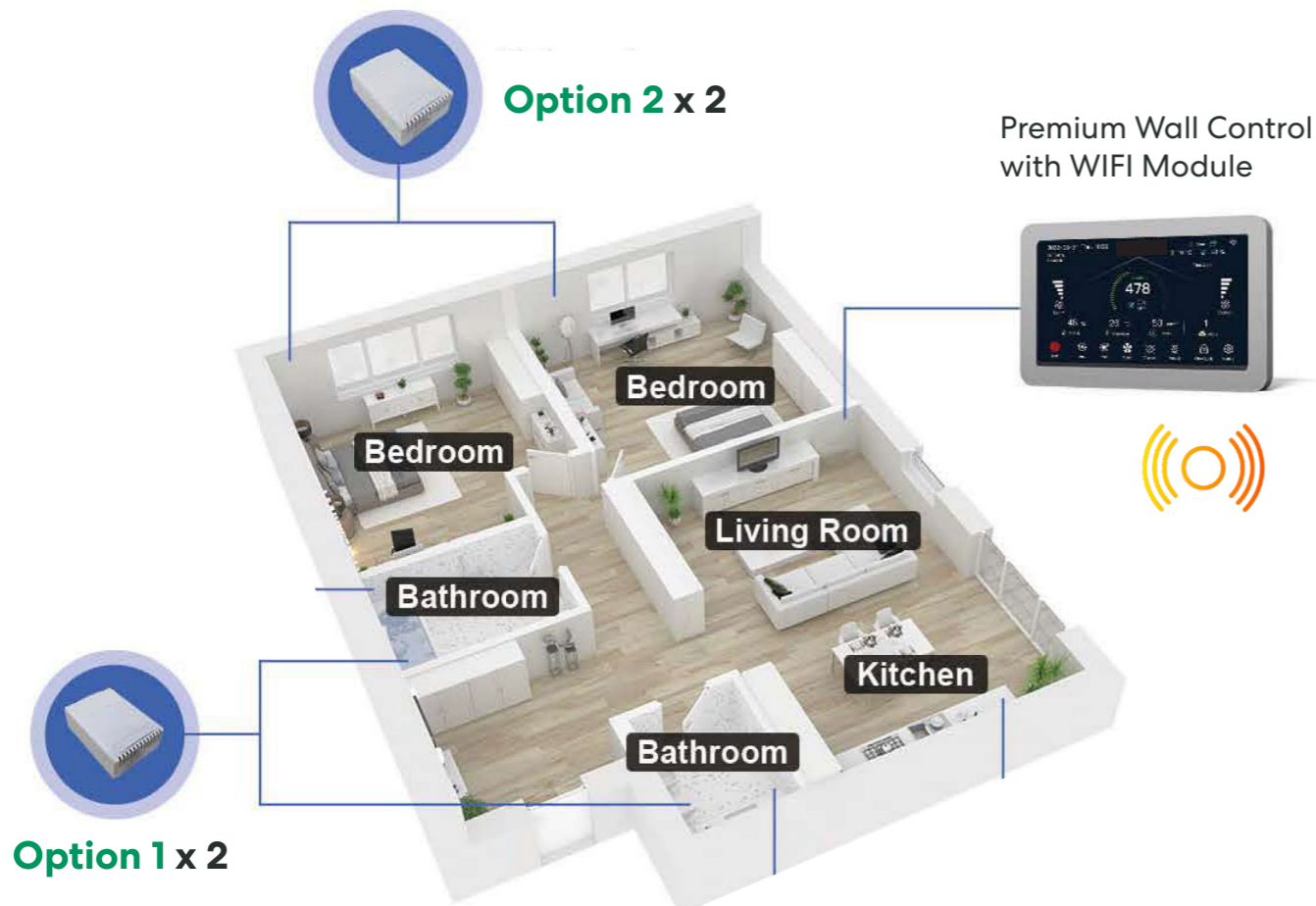

## How does it work?

A heat recovery unit (HRV) is designed to introduce fresh, filtered air into the home, whilst also removing stale, moisture laden air.

As the warm, moisture laden air is extracted from the kitchen and bathrooms, it passes through the heat exchanger, which accumulates heat during this process.

Simultaneously, fresh air from the outside is drawn into the system, passing through the heat exchanger. This ensures it is warm before entering the living space. The air also passes through a filter (see exploded product view below).

This cycle is critical to maintaining indoor air quality.

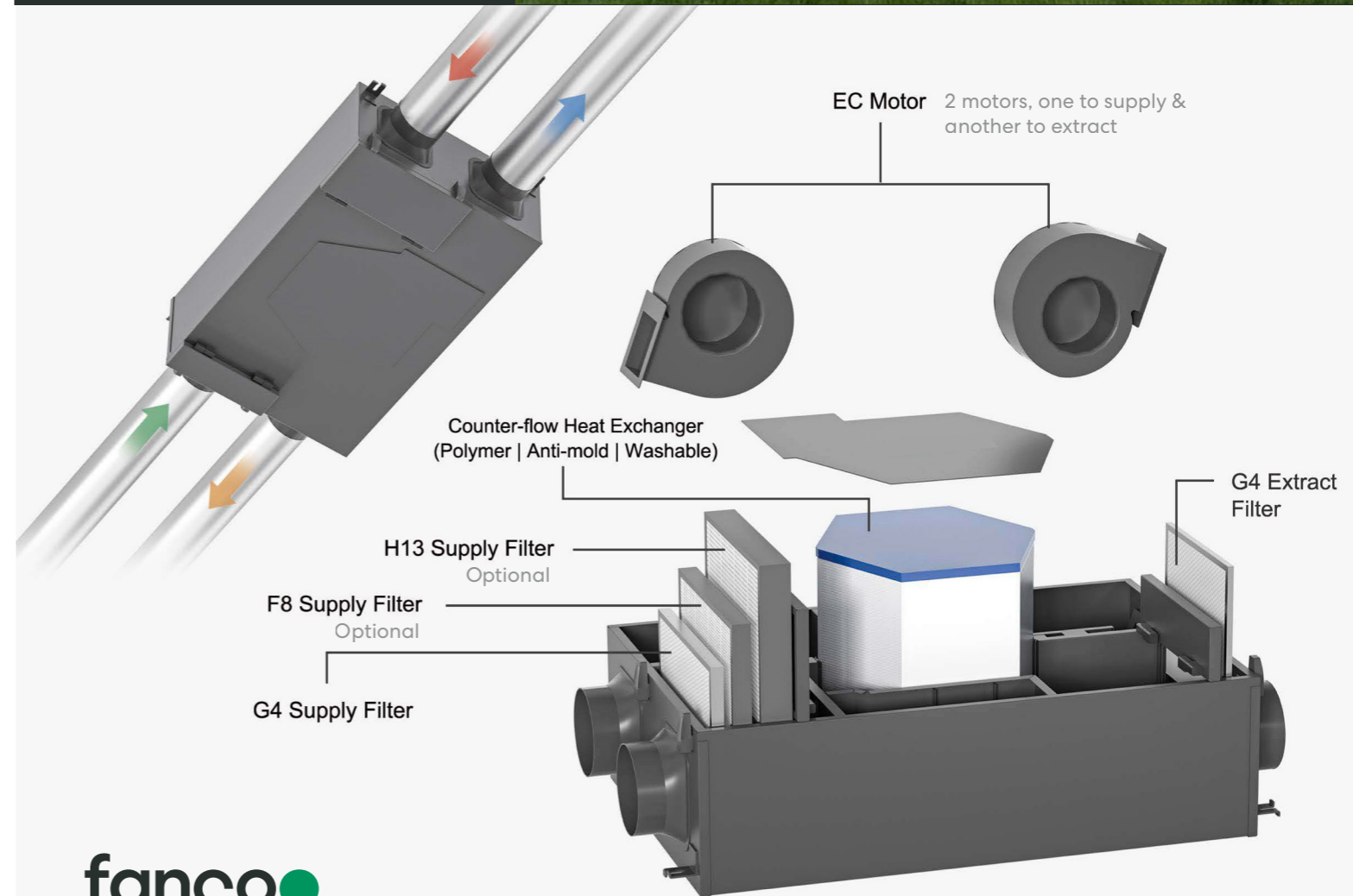
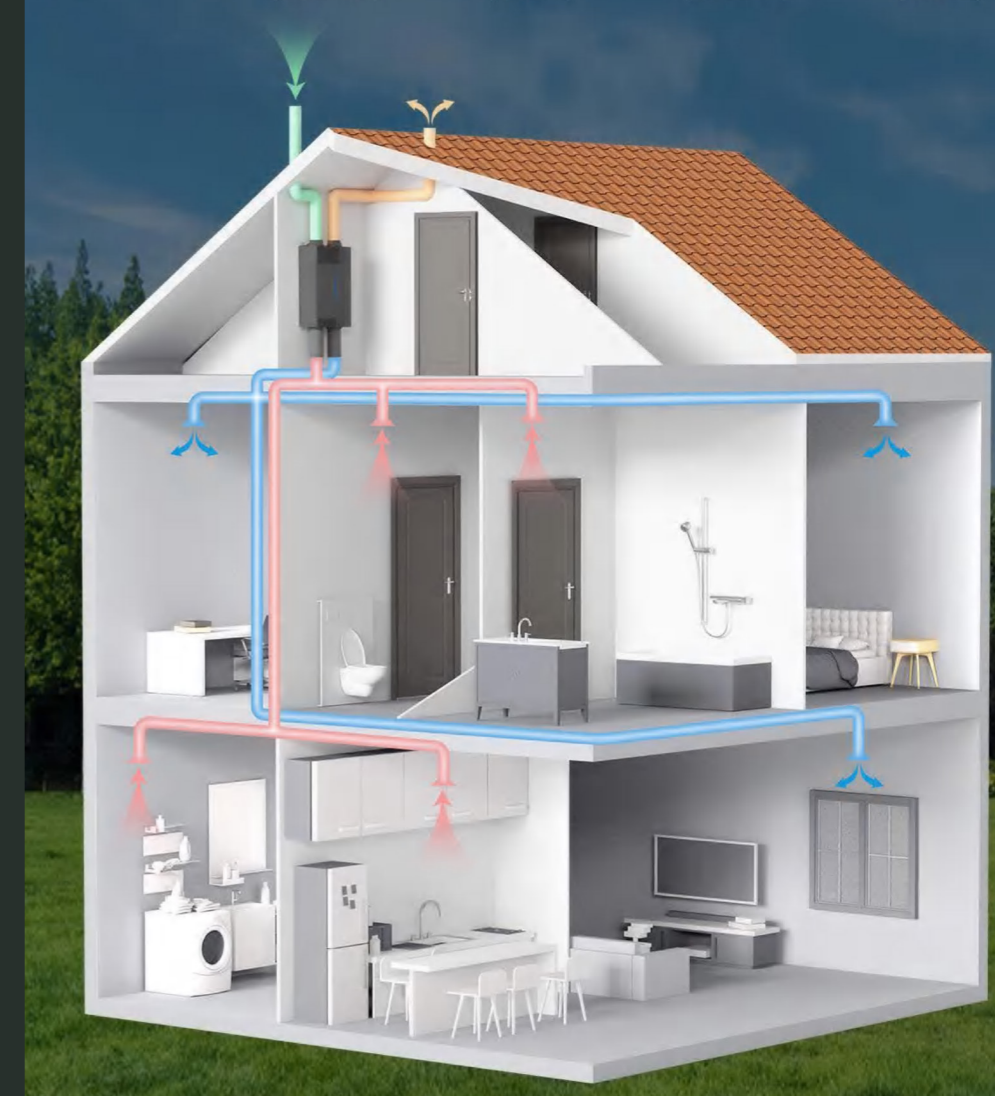

**fanco●**